



FOR LEASE

1910 E DOMINGUEZ STREET, CARSON, CA 90810

Property Highlights

- 30,785 SF Industrial Building for Lease
- Located on 60,249 SF of Land
- 3 Dock High Positions/2 Grade Level Doors
- 3,200 SF Office
- 46 Car Parking
- 400 Amp 120/240 Volt Power
- .21/2040 Calculated Sprinkler System
- 21'-23' Clearance
- Private Yard Area Suitable for Product/Trailer Storage

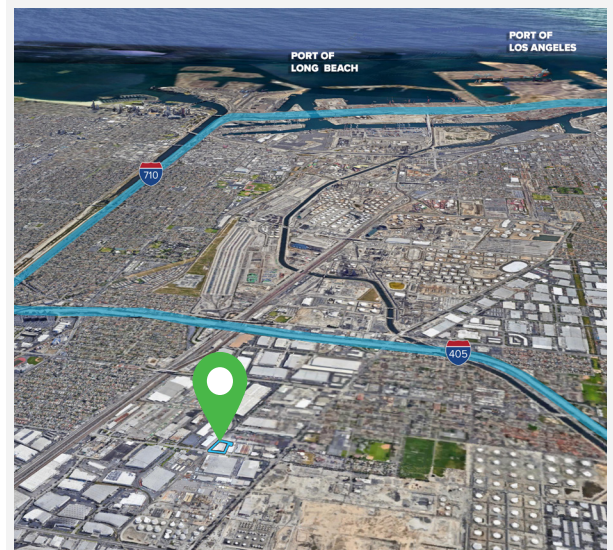

South Bay Submarket

For Leasing Information:

Mike Ouellette
(310) 329-9000 x1170
mikeo@klabin.com

Nick Buss, SIOR
(310) 329-9000 x1160
nickb@klabin.com

Frank Schulz, SIOR
(310) 329-9000 x1100
franks@klabin.com

Parker Hutchison
(949) 351-2163
parker.hutchison@bridgelp.com

Leased by:



Owned by:



FOR LEASE

1910 E DOMINGUEZ STREET, CARSON, CA 90810



1.2 MI to 405 Fwy
2.3 MI to 710 Fwy
4.1 MI to 110 Fwy



10.5 MI to Port of LA
10.6 MI to Port of LB



8.0 MI to LGB
15.1 MI to LAX



For Leasing Information:

Mike Ouellette
(310) 329-9000 x1170
mikeo@klabin.com

Nick Buss, SIOR
(310) 329-9000 x1160
nickb@klabin.com

Frank Schulz, SIOR
(310) 329-9000 x1100
franks@klabin.com

Parker Hutchison
(949) 351-2163
parker.hutchison@bridgelp.com

Leased by:



Owned by:



Bridge does not have the responsibility to update the information to account for changes and makes no representation or warranty, expressed or implied, with respect to the accuracy or completeness of any of the information contained herein.

FOR LEASE

1910 E DOMINGUEZ STREET, CARSON, CA 90810

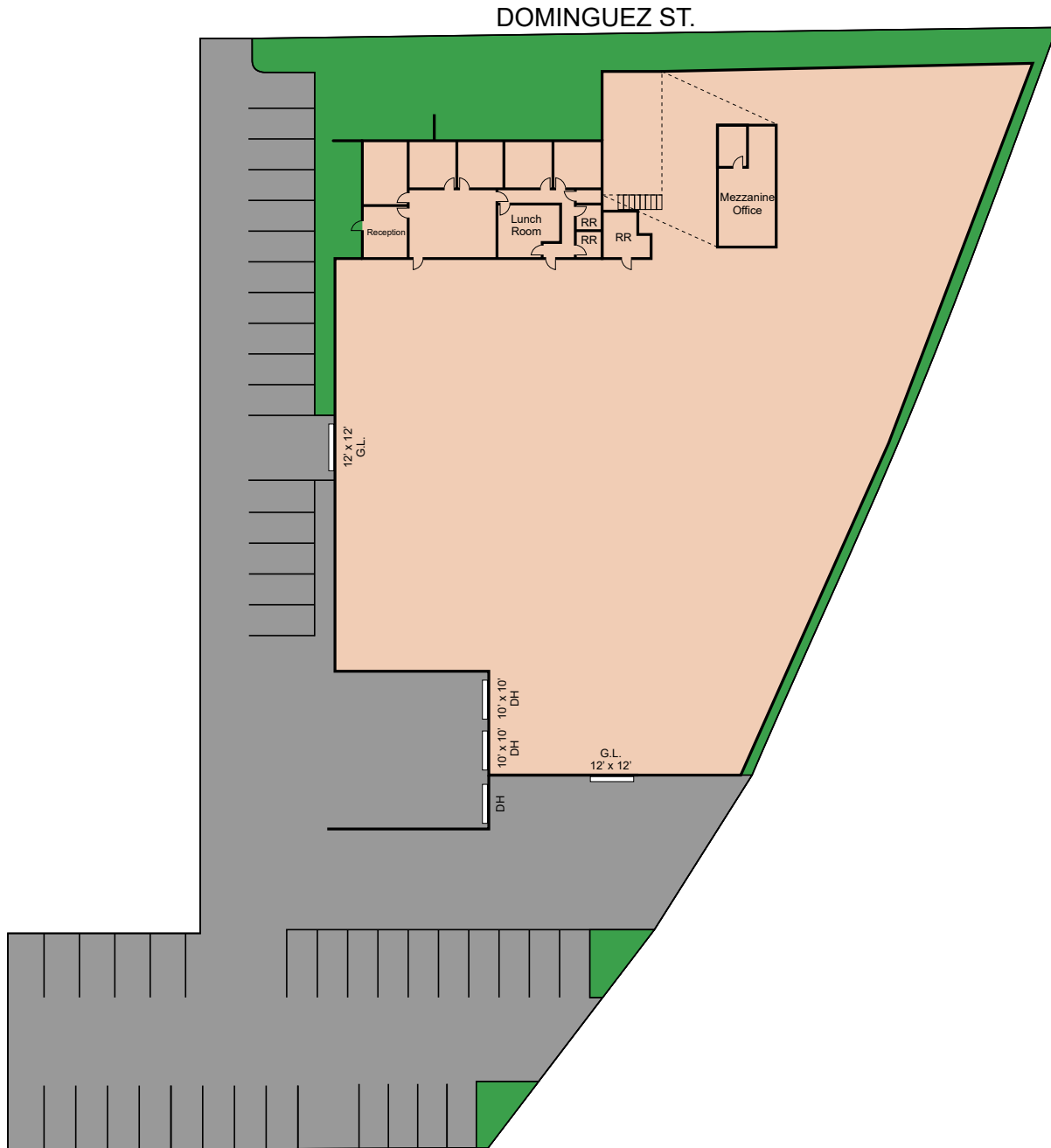

For Leasing Information:

Mike Ouellette
(310) 329-9000 x1170
mikeo@klabin.com

Nick Buss, SIOR
(310) 329-9000 x1160
nickb@klabin.com

Frank Schulz, SIOR
(310) 329-9000 x1100
franks@klabin.com

Parker Hutchison
(949) 351-2163
parker.hutchison@bridgelp.com

Leased by:



Owned by:

